

# PiCGENIE<sup>123</sup>®

## INTERCHANGE PICTURES

If you would like to switch picture frames in and out on your wall for a different look for each season or occasion of the year, there is a very easy way to do it using PicGenie123™.

- (1) Make a template using a stiff paperboard, like the one shown below. Make 90° cut-outs on each end. Make the template about the same width your frames are, so it will be easy to work with. You will use this one template on all your frames you want to make interchangeable on your wall. The length of the template can be of your choosing. This is a great solution for frames that are 10" or wider.
- (2) Next, tape your template to your frame making sure it's flush with the top edge of your frame and tape it to the frame using masking tape.
- (3) The template allows you to easily position the brackets in the cut-out corner area on each end of the template, as shown. Attach the brackets to the frame as they remain positioned in the 90° cut-out corners. Then, hang your picture using the standard PicGenie123™ picture hanging instructions.

Repeat these steps for each frame you want to interchange with others. Then you can simply take one picture down and put up a different one for each season or occasion, and it's fast, fun and easy-to-do.

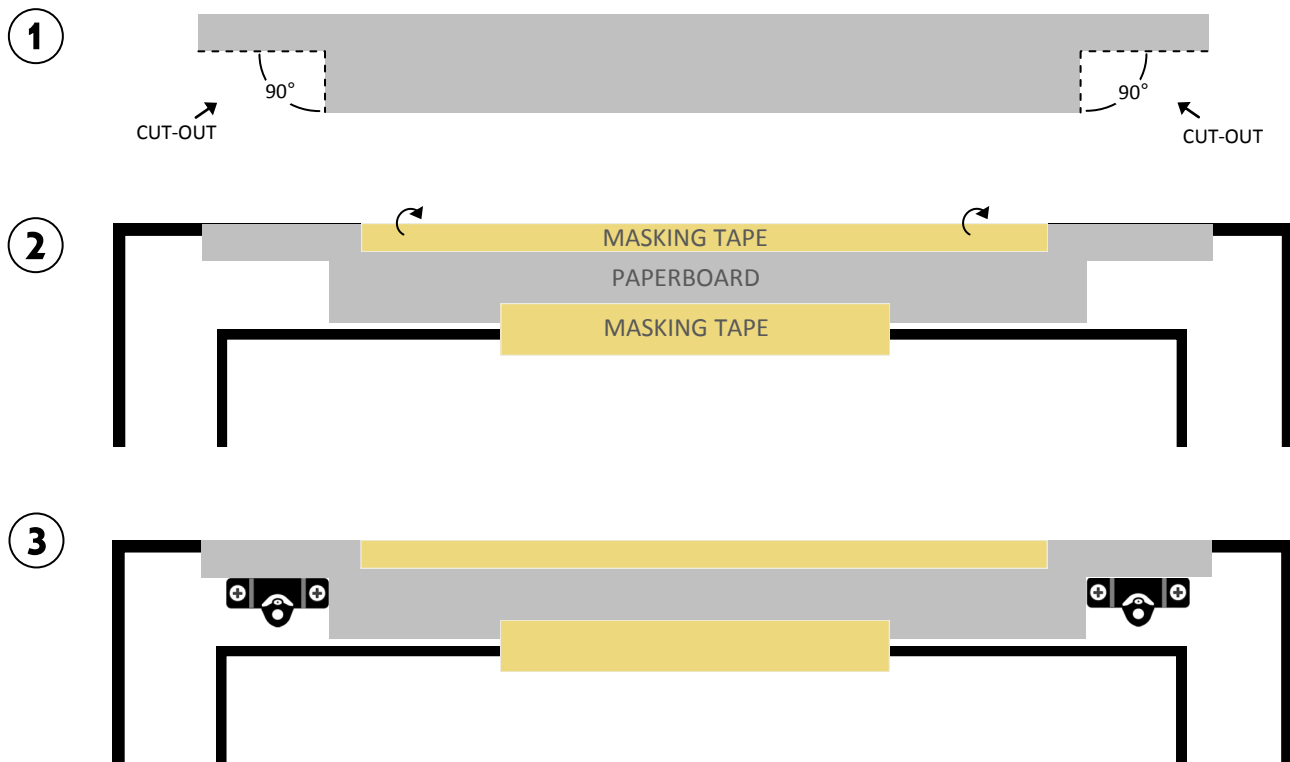

# PiCGENIE<sup>123</sup>®

*Picture Hanging Made Easy!*